

# TuffStrand - WRB™ Weather Resistant Barrier

Product Information & Installation Manual

RoyOMartin®

UNCOMPROMISING  
QUALITY.

UNWAVERING  
COMMITMENT.

RoyOMartin®

# TuffStrand - WRB™ Weather Resistant Barrier

RoyOMartin®  
**BUILDING  
TOMORROW**  
*Together*



(800) 299-5174  
[info@royomartin.com](mailto:info@royomartin.com)  
[RoyOMartin.com](http://RoyOMartin.com)

PO Box 1110 | Alexandria, LA 71309-1110



# TuffStrand - WRB™ Weather Resistant Barrier

## Product Information & Installation Manual

RoyOMartin®

### Important Notice to Buyers and Users of RoyOMartin TuffStrand-WRB™

This product is designed to meet international building codes; however, local building codes may supersede. These instructions are not intended to cover every installation requirement, application, detail or variation, nor do they provide for every possible installation contingency. If any questions or problems arise concerning the installation of this product or its suitability for the purchaser's particular use, inquiries should be made to RoyOMartin at [royomartin.com](http://royomartin.com). The information about products and application instructions printed herein is current at the time of publication; however, in accordance with RoyOMartin's policy of constant product improvement, the right is reserved to vary these application instructions and product specifications without notice. Ask for the most current product information when placing product orders.

### Product Description

TuffStrand Weather Resistant Barrier™ delivers a superior housewrap tape-and-panel solution, integrating a weather resistant barrier with the durability of a structural panel.

### TuffStrand-WRB™ Consists of:

- Weather resistant barrier OSB panels
- RoyOMartin-approved 5-inch woven tape

### Application

TuffStrand Weather Resistant Barrier™ is designed for applications requiring a structural panel, ideally suited for exterior walls. See Tuffstrand product information and installation instructions for proper span ratings and nailing patterns.

### Product Warranty

TuffStrand Weather Resistant Barrier™ has an exposure rating of 180 days. See RoyOMartin's 25-year limited warranty for details.

### Storage & Handling

Like any wood product, TuffStrand Weather Resistant Barrier™ should be stored to avoid excessive moisture pick-up and should be covered.

### Certification

TuffStrand Weather Resistant Barrier™ is certified by APA—The Engineered Wood Association, and is manufactured in conformance with APA PRP-108 and U.S. Voluntary Product Standard PS2.

TuffStrand Weather Resistant Barrier™ meets the following testing standards:

- ASTM Test Method E 84 Surface Burn, Smoke Development: Class "B"
- ASTM Test Method E 96-05 Vapor Transmission: < 1 perm
- ASTM Test Method E 331 Water Penetration
- ASTM Test Method E 2178-03 (Air Permeance): < .02
- ASTM Test Method E 2273: 96.7%
- ASTM Test Method D 2247 Water Resistance Measurement
- ICCES AC 310 Water Resistance Measurement

### Lengths

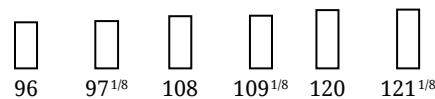

Lengths are nominal. All widths are 48" (nominal)

### Thicknesses

7/16, 15/32 & 19/32

Performance categories

### Span Ratings

- 7/16"    24/16
- 15/32"    32/16
- 19/32"    40/20

**All RoyOMartin products are American made.**



(800) 299-5174  
[info@royomartin.com](mailto:info@royomartin.com)  
[RoyOMartin.com](http://RoyOMartin.com)

PO Box 1110 | Alexandria, LA 71309-1110



# General Installation Requirements

TuffStrand-WRB™

## 2.1

Install TuffStrand Weather Resistant Barrier™ with weather resistant barrier facing outward adhering to local building codes. Surface should be dust/dirt free before taping and flashing.

- Circular saw cuts must be made with the weather resistant barrier facing down to avoid damage to the weather resistant barrier.
- Vertical application is recommended.
- Blocking should be used at all joints.
- Use expandable foam to repair any small wall protrusions or breaches in the weather resistant barrier after the finished exterior siding is installed.
- Torn spots on TuffStrand Weather Resistant Barrier or damaged adhesive tape should be repaired.
- See TuffStrand installation guide for (span rating and) fastener details.

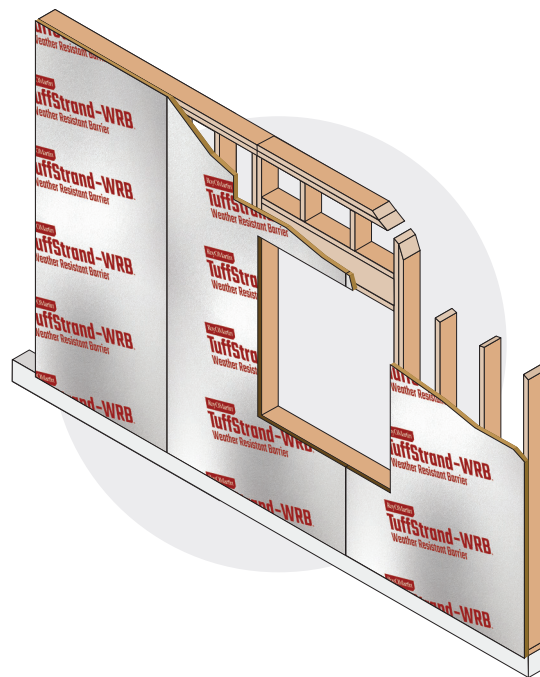

## 2.2

Attach TuffStrand Weather Resistant Barrier™ to stud wall with 1/8 inch space between panel edges in accordance with industry standards for wood sheathing installation.

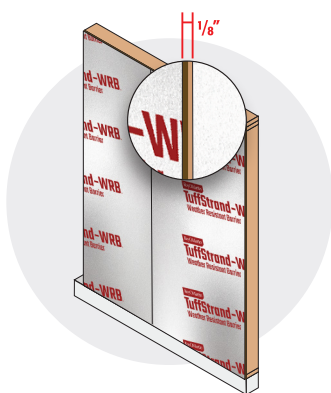

## 2.3

Clean surface before taping. **Tape all seams and corners with approved tape. For best taping results, apply a minimum of 8 lbs. of pressure to the tape. A squeegee applicator should achieve this amount of pressure.**



**All openings – including windows, doors, wall vents and penetration openings – must be installed using IBC-approved adhesive flashing. All exposed edges must be covered immediately to prevent wood swell (temporary covering permitted).**

Window Installation – Section 3.0

Rectangular Vent Installation – Section 5.0

Wall-Roof Interface Installation – Section 7.0

Door Installation – Section 4.0

Triangular Vent Installation – Section 6.0

*Note: These are common or typical installation instructions. These Instructions may not cover every possible installation.*

# Window Installation

TuffStrand-WRB™

## 3.1

**Fasten TuffStrand Weather Resistant Barrier™ panels to wood frame and apply approved tape as detailed in section 2.0.**

Cover exposed edges with temporary flashing until permanent flashing is installed.

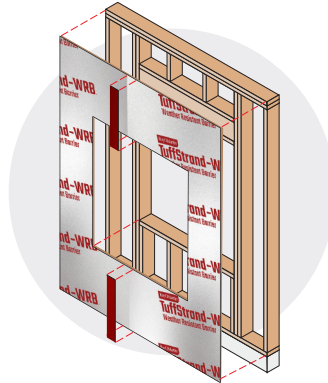

## 3.2

It is critical to cover window sill immediately. This will minimize wood swell. Measure and cut IBC-approved adhesive flashing length at least 12" longer than horizontal length of sill plate.

Flashing width should be sufficient to cover sill plate plus a minimum of 2" on exterior of TuffStrand.

Notch, fold and apply flashing to cover sill plate, ensuring a 6" long strip of flashing to both vertical sides.

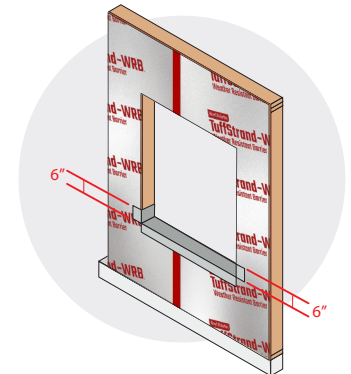
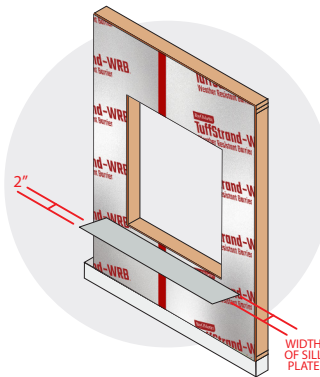
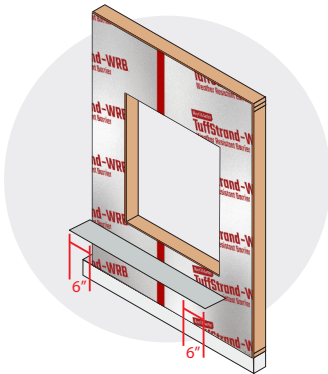

## 3.3

Install window according to manufacturer's instructions, adhering to all local building codes.

Measure and cut IBC-approved adhesive flashing length at least 2" longer than vertical length of window. Apply flashing overlapping window frame at least 1".

Repeat process for top of window, overlapping previously applied flashing at least 2".

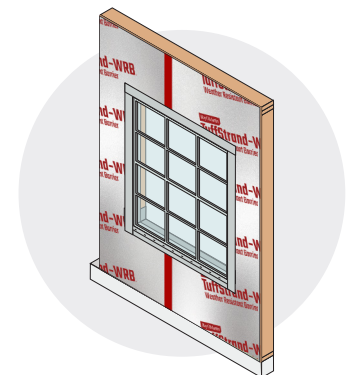
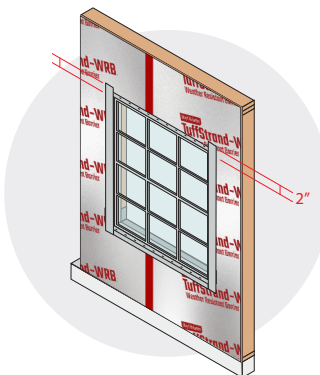
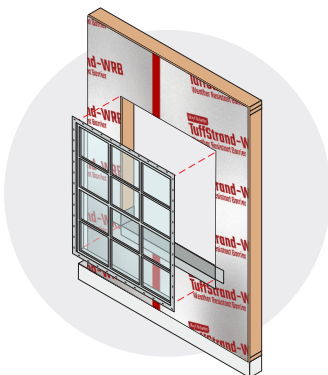



## 4.1

## Fasten TuffStrand Weather Resistant Barrier™ panels to wood frame and apply approved tape as detailed in section 2.0.

Cover exposed edges with temporary flashing until permanent flashing is installed.

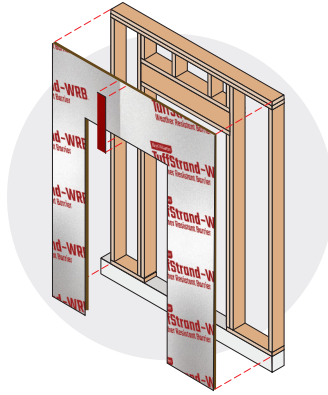

## 4.2

Measure and cut IBC-approved adhesive flashing length at least 2" longer than vertical length of door jamb.

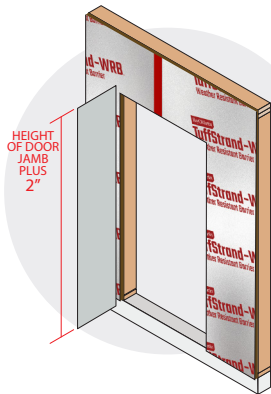

Flashing width should be sufficient to cover door jamb plus 2" on exterior of TuffStrand.

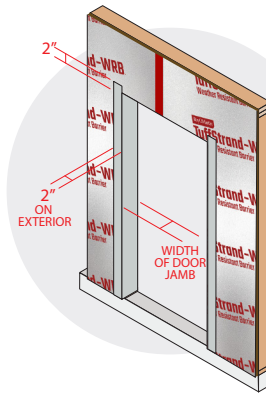

Notch, fold and apply flashing to cover door jamb. Install on vertical sides of door jamb.

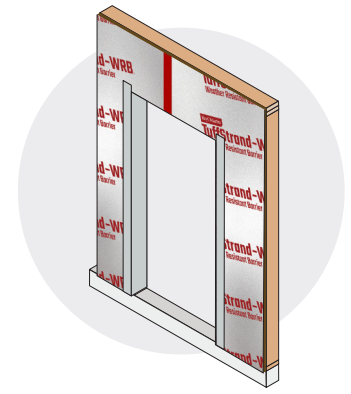

## 4.3

Measure and cut IBC-approved adhesive flashing length at least 2" longer than horizontal length of the head door jamb.

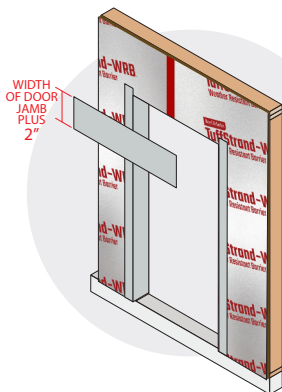

Measure and cut flashing width sufficient to cover head door jamb plus 2" on exterior of TuffStrand.

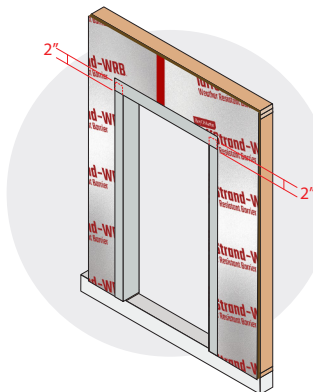

Notch, fold and apply flashing to cover head door jamb.

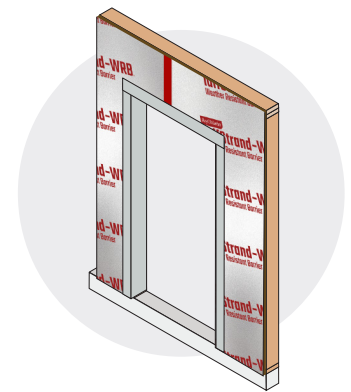

# Rectangular Vent Installation

TuffStrand-WRB™

## 5.1

**Fasten TuffStrand Weather Resistant Barrier™ panels to wood frame and apply approved tape as detailed in section 2.0.**

Cover exposed edges with temporary flashing until permanent flashing is installed.

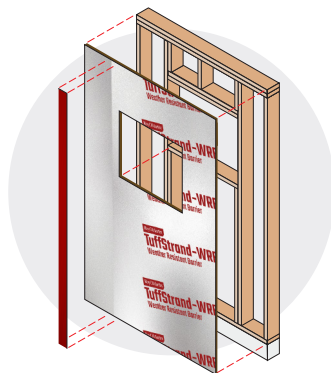

## 5.2

Measure and cut IBC-approved adhesive flashing length at least 12" longer than horizontal length of vent jamb.

Flashing width should be sufficient to cover vent jamb plus a minimum of 2" on exterior of TuffStrand.

Notch, fold and apply flashing to cover entire vent jamb, ensuring a 6" long strip of flashing to both vertical sides.

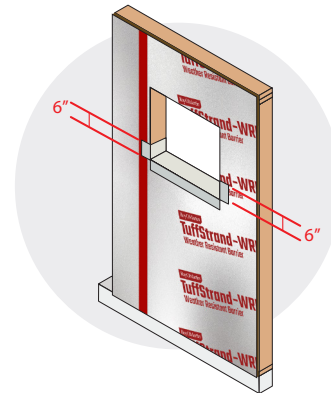
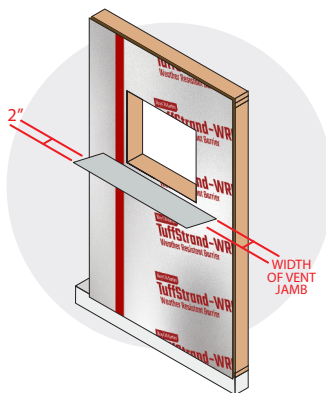
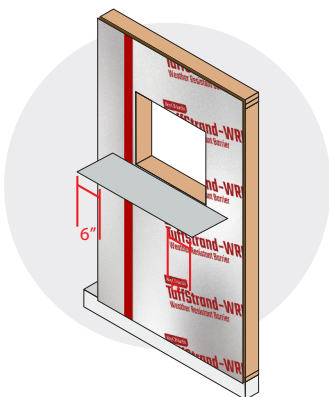

## 5.3

Install vent according to manufacturer's instructions, adhering to all local building codes.

Measure and cut IBC-approved adhesive flashing length at least 2" longer than vertical length of vent. Apply flashing overlapping vent frame at least 1".

Repeat process for top of vent, overlapping previously applied flashing at least 2".

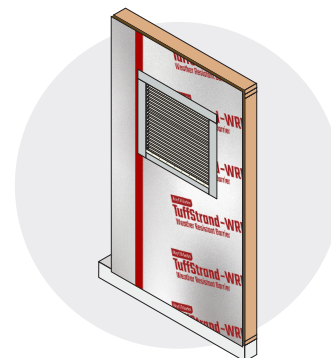
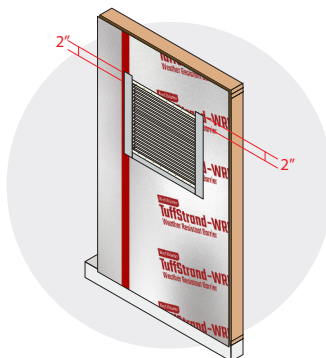
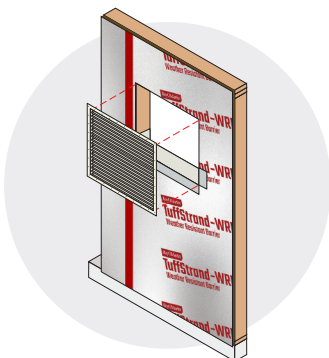

# Triangular Vent Installation

TuffStrand-WRB™

## 6.1

**Fasten TuffStrand Weather Resistant Barrier™ panels to wood frame and apply approved tape as detailed in section 2.0.**

Cover exposed edges with temporary flashing until permanent flashing is installed.



## 6.2

Measure and cut IBC-approved adhesive flashing length at least 12" longer than horizontal length of vent jamb.

Flashing width should be sufficient to cover vent jamb plus a minimum of 2" on exterior of TuffStrand.

Notch, fold and apply flashing to cover vent jamb, ensuring a 6" long strip of flashing to both triangular sides.

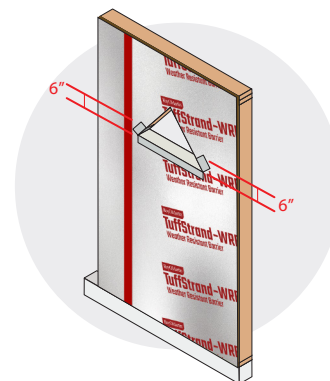
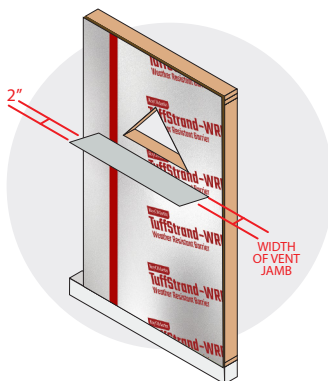
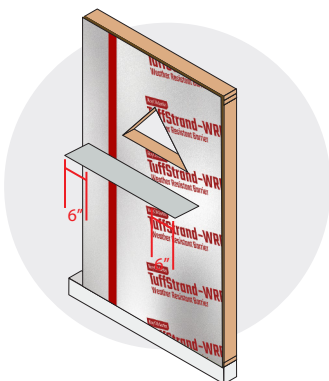

## 6.3

Install vent according to manufacturer's instructions, adhering to all local building codes.

Measure and cut IBC-approved adhesive flashing length at least 2" longer than triangular length of vent. Apply flashing overlapping vent frame at least 1" and overlapping flashing at top of triangular frame.

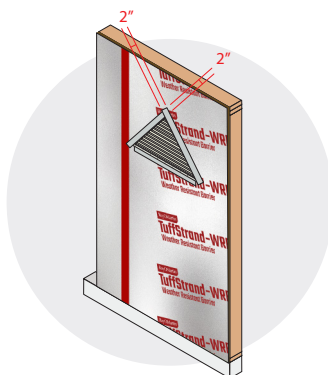
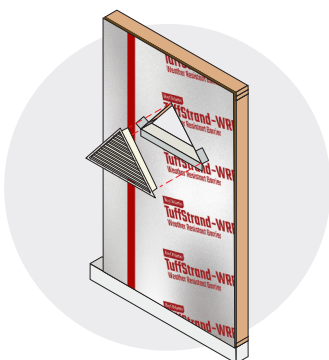

# Sidewall-Roof Installation

TuffStrand-WRB™

## 7.1

**Fasten TuffStrand Weather Resistant Barrier™ panels to wood frame and apply approved tape as detailed in section 2.0.**

Cover exposed edges with temporary flashing until permanent flashing is installed.

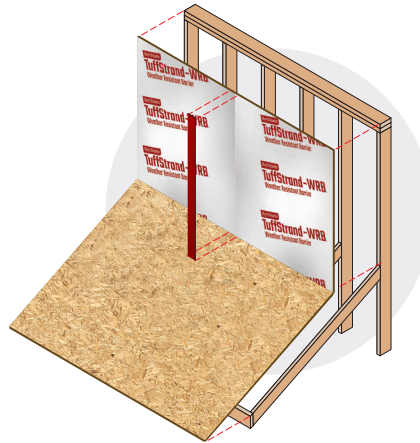

## 7.2

Install roofing underlayment according to manufacturer's instructions, adhering to all local building codes.

Measure and cut IBC-approved adhesive flashing width at least 12". Install 6" of flashing to TuffStrand on wall and 6" of flashing to roofing underlayment.

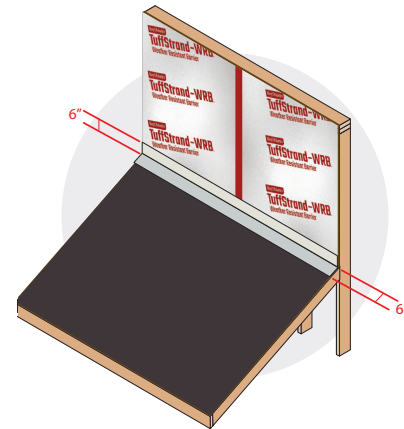
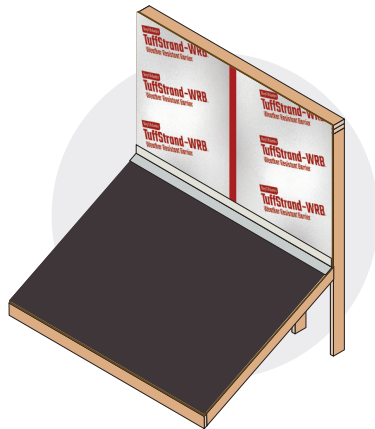

## 7.3

Apply roofing system and metal roofing flashing according to manufacturer's instructions, adhering to all local building codes.

Install exterior wall system according to manufacturer's instructions, adhering to all local building codes.

